

# Model PC

## "Tea Cup" Pipe Carrier

**Product Features:**

- An efficient way to handle concrete water and sewer pipes
- The Caldwell "Tea Cup" Pipe Carrier will save you time and money
- Three sizes available, to handle from 3/4" to 1-1/2" cable, and lift up to 18 tons
- Optional "Spoon Handle" allows the PC-3/4 "Tea Cup" to be guided into small diameter pipes
- Complies with ASME standards
- **Option SH Spoon Handle:** 61.1"L with a slight bend for ease of use; only for PC-3/4; to order, use Model Number SH-34

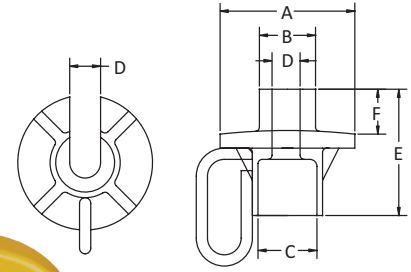

Model Number	Rated Capacity (tons)	Rope Dia. (in.)	Dimensions (in.)						Weight (lbs.)
			A	B	C	D	E	F	
PC-3/4*	6.6	3/4	5.56	2	2.13	1.13	4.75	1.75	9
PC-1	13	1	6	2.50	2.63	1.38	5.75	1.75	12
PC-1 1/2	18	1-1/2	8	3	3.25	1.63	7.63	2.75	22

IN STOCK  
IN STOCK  
IN STOCK

**! WARNING**  
Use only for vertical lifting.

\*Can use "Spoon Handle" with this model.

# Model PC

## Low-Profile "Tea Cup" Pipe Carrier

Same great engineering as the standard model, but only wire rope needs to be inserted through pipe.

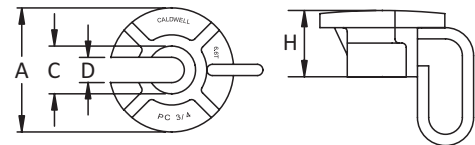

Model Number	Rated Capacity (tons)	Rope Dia. (in.)	Dimensions (in.)				Weight (lbs.)
			A	C	D	H	
PC-3/4-F*	6.6	3/4	5.56	2.13	1.13	3.44	9
PC-1-F	13	1	6	2.63	1.38	4.38	12
PC-1 1/2-F	18	1-1/2	8	3.25	1.63	5.13	22

IN STOCK  
IN STOCK  
IN STOCK

\*Can use "Spoon Handle" with this model.

### PRODUCT OPERATION

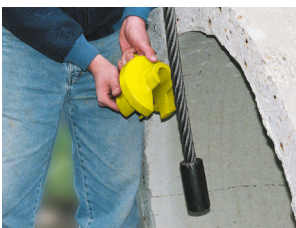

Drop pipe carrier lifting sling through hole in pipe. Align and insert "Tea Cup" pipe carrier into lifting sling.

Once set, you are ready to lift the pipe.